

**ITEM 11. ITEM FOR COMMITTEE INFORMATION – CYCLEWAY –
CASTLEREAGH STREET FROM GOULBURN STREET TO
LIVERPOOL STREET SYDNEY**

TRIM RECORD NO: 2015/009661

RECOMMENDATION

It is recommended that the Committee note the following:

- (A) Reallocation of parking on the western side of Castlereagh Street between the points 0 metres and 133.1 metres south of Liverpool Street as “No Stopping”, and
- (B) Reallocation of parking on the eastern side of Castlereagh Street between the points 39.8 metres and 76.8 metres south of Liverpool Street as “Bus Zone”, and
- (C) Reallocation of parking on the eastern side of Castlereagh Street between the points 76.8 metres and 129.8 metres south of Liverpool Street as “No Stopping”; and
- (D) Installation of kerb amendments and changes to lane configuration in Castlereagh Street between Goulburn Street and Liverpool Street.

DECISION

BACKGROUND

The parking changes are proposed as part of the Sydney City Centre Access Strategy which was adopted by the NSW Government in December 2013. The Access Strategy prioritises and allocates street space for public transport, general traffic, pedestrians, cyclists, taxis and service vehicles. Integrated bus plan and cycle infrastructure are key features of the proposed integrated network.

Castlereagh Street between Hay Street and Liverpool Street is identified in the Sydney City Centre Access Strategy as a key bus corridor. The bus corridor includes “No Stopping”, “Bus Zone” and “Bus Lane 6am-8pm Mon-Fri 10am-6pm Sat” on the eastern side of Castlereagh Street.

Castlereagh Street between Hay Street and Liverpool Street is identified in the Sydney City Centre Access Strategy as a key cyclist corridor. The cycleway includes “No Stopping” on the western side of Castlereagh Street.

COMMENTS

The kerb space on the western side of Castlereagh Street between Goulburn Street and Liverpool Street is generally signposted as “No Stopping”, “No Parking”, “Loading Zone Ticket 7am-6pm Mon – Fri 7am – 10am Sat”, “1P Ticket 8am-6pm Mon-Fri” and “4P Ticket 6pm-10pm Mon-Fri, 10am-10pm Sat, 8am-10pm Sun & Public Holidays”.

The kerb space on the eastern side of Castlereagh Street between Goulburn Street and Liverpool Street is generally signposted as “Bus zone”, “1P Ticket” and “4P Ticket”.

Where possible, loading, taxi and parking for people with disabilities will be distributed to neighbouring streets, contained within the proposed changes for the bus and cycleway plans.

As part of the proposal a bus lane is proposed on the eastern side of Castlereagh St, between the hours of 6am-8pm Mon-Fri, 10am-6pm Sat, Sun and Public Holidays.

Agreement was obtained from the RMS, the Sydney City Police and the State Member, for the proposed changes.

CONSULTATION

The Roads and Maritime Service carried out a letter drop consultation as well as contacting individual affected stakeholders individually in the affected area. The consultation process had 38,000 letters sent out and 127 responses in total were received. Of the above overall responses, there were 56 responses supporting the proposal and 67 responses opposing the proposal. Two neither support nor object and one was out of scope.

Submissions opposing the proposal were concerned about the loss of loading and parking spaces.

Submissions supporting the proposal believed the proposal would improve access to the City and reduce general traffic congestion.

FINANCIAL

The project is being funded by Transport for NSW and City of Sydney.

ATTACHMENTS

Item for Committee Information – Cycleway – Castlereagh Street from Goulburn Street to Liverpool Street Sydney

Stephen Sherwin, Project Manager – Roads and Maritime Services

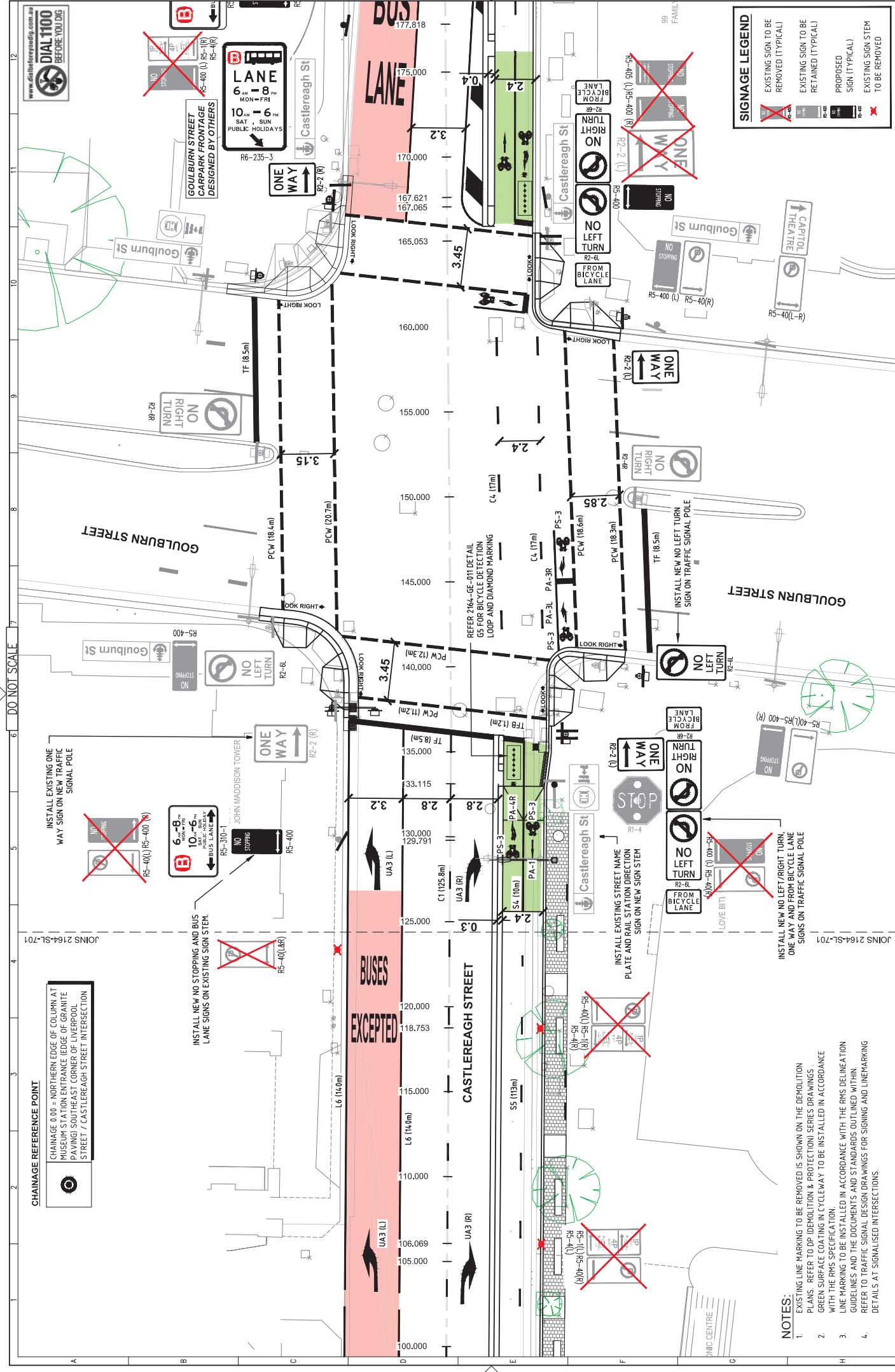

NOTES:

- EXISTING LINE MARKING TO BE REMOVED IS SHOWN ON THE DEMOLITION PLANS. REFER TO DP (DEMOLITION & PROTECTION) SERIES DRAWINGS.
- GREEN SURFACE COATING IN CYCLEWAY TO BE INSTALLED IN ACCORDANCE WITH THE RMS SPECIFICATION.
- LINE MARKING TO BE INSTALLED IN ACCORDANCE WITH THE RMS DELINEATION GUIDELINES AND THE DOCUMENTS AND STANDARDS OUTLINED WITHIN. REFER TO TRAFFIC SIGNAL DESIGN DRAWINGS FOR SIGNING AND LINE MARKING. DETAILS AT SIGNALISED INTERSECTIONS.

<p>10 Regent Street Chippendale NSW 2008</p> <p>Scale 1:100 (A1)</p> <p>DATE: 15/10/14</p> <p>DESIGNER: GBD ALLIANCE</p> <p>CHECKER: GBD ALLIANCE</p> <p>APPROVER: GBD ALLIANCE</p> <p>PROJECT: CBD ALLIANCE - LIVERPOOL STREET CYCLEWAY</p> <p>BLOCK: 6, LIVERPOOL STREET TO GOULBURN STREET</p> <p>SIGNS AND LINE MARKING PLAN</p> <p>SHEET 3 OF 3</p> <p>DRG: 2.164-SL-603</p>	
<p>COMPLETE</p> <p>www.completeurban.com.au</p>	
<p>323 Castlereagh Street Via Hay Street Sydney NSW 2000, Australia</p> <p>www.completeurban.com.au</p>	
<p>ISSUED FOR CONSTRUCTION</p>	
<p>3. FOR CONSTRUCTION</p> <p>15/10/14</p>	<p>15/10/14</p>
<p>2. FOR CONSTRUCTION</p> <p>14/10/14</p>	<p>14/10/14</p>
<p>1. FOR CONSTRUCTION</p> <p>07/10/14</p>	<p>07/10/14</p>
<p>A. FINAL DETAILED DESIGN - 06/10/14</p>	<p>06/10/14</p>
<p>Revision: Make on GBD file email by hand</p>	<p>Date</p>
<p>Scale 1:100</p> <p>A1 UNREduced</p>	<p>Scale 1:100</p> <p>A1 UNREduced</p>

